

TIDE SHELTER INSTRUCTIONS

Model no. KC074-016

Please read instructions before setting up Shelter.

SET UP

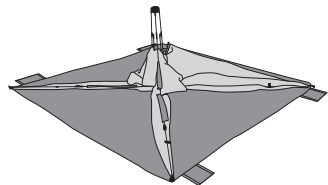

Lay shelter flat with central hub upright. Make sure poles are fully extended.

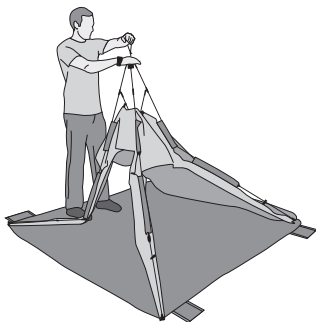

Standing behind the shelter, pull the drawstring up with one hand while holding the top of the hub in place with the other hand.



Continue to pull until the upper and lower sections of the hub connect. As hubs get closer to connecting, the resistance will increase and the body of the shelter will bow out and lock into place.

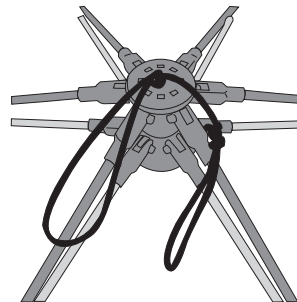

IMPORTANT: Once connected, tie the drawstring in a small knot. This will prevent the possibility of the shelter collapsing.

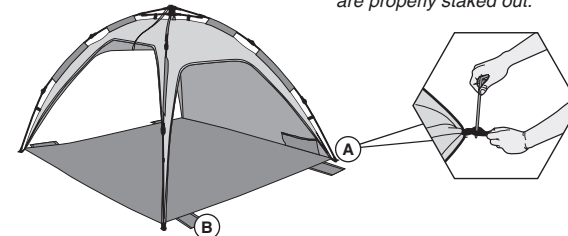

Note: The shelter is most secure when the corners and guy lines are properly staked out.

Stake down the corners of the shelter to secure in place (A). Sand pockets can be filled for additional stability (B).

TAKE DOWN

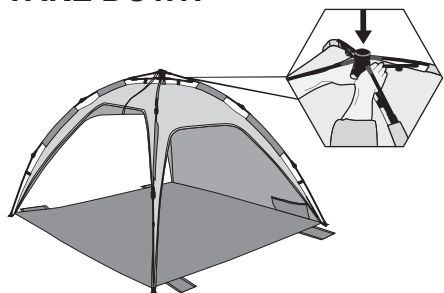

Remove stakes. Untie cords and separate central hub by pushing down on the lower hub poles.

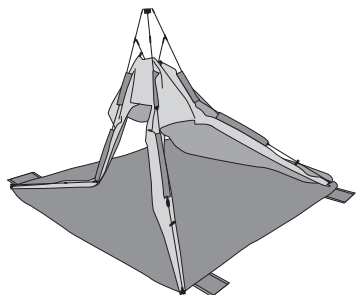

Gently lower down the entire shelter.

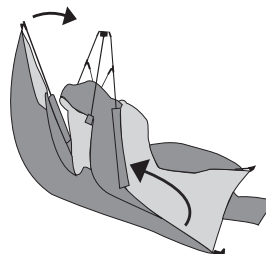

Holding central hub upright, fold poles up toward the hub.

PACKAGING THE SHELTER

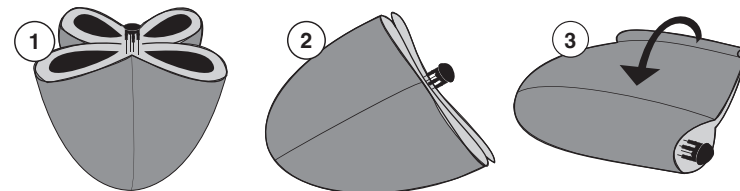

1. Fold poles toward the central hub and allow loose fabric to flower out.
2. Lay the folded shelter on its side. All 4 poles should be tight to the hub in order to prevent pole damage.
3. Bring all excess fabric together and roll tightly toward the central hub.



Warning: Keep body parts clear of pole joints during operation.

Never use aerosols or insect repellent sprays in or around the fabric of your shelter as it can damage the water-proofing and is not covered by warranty.